

Models

- GEM TS
- GEM SS

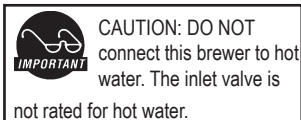
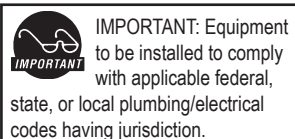

WILBUR CURTIS COMPANY, INC.

Gemini Twin & Single Brewers – Instructions

Important Safeguards/Conventions

This appliance is designed for commercial use. Any servicing other than cleaning and maintenance should be performed by an authorized Wilbur Curtis service center.

- Do NOT immerse the unit in water or any other liquid
- To reduce the risk of fire or electric shock, do NOT open top panel. No user serviceable parts inside. Repair should be done only by authorized service personnel.
- Keep hands and other items away from hot parts of unit during operation.
- Never clean with scouring powders, bleach or harsh implements.

Conventions



WARNINGS – To help avoid personal injury



Important Notes/Cautions – from the factory



Sanitation Requirements

Your Curtis G3 System is Factory Pre-Set and Ready to Go... Right from the Carton.

Following are the Factory Settings for your interLock Coffee Brewing Systems:

- Brew Temperature = 200°F
- Brew Volume = Large set to vessel requirements.
- Water Bypass = On LARGE & MEDIUM brew only
- Energy Save Mode = Off

System Requirements:

- Water Source 20 – 90 PSI (Minimum Flow Rate of 1 GPM)
- Electrical: See attached schematic for standard model or visit www.wilburcurtis.com for your model.

SETUP STEPS

The unit should be level (left to right and front to back), located on a solid counter top. Connect a water line from the water filter to the brewer. **NOTE:** Some type of water filtration device must be used to maintain a trouble-free operation. (In areas with extremely hard water, we suggest that a sedimentary and taste & odor filter be installed.) This will prolong the life of your brewing system and enhance coffee quality.



NSF International requires the following water connection:

1. A quick disconnect or additional coiled tubing (at least 2x the depth of the unit) so that the machine can be moved for cleaning underneath.
2. In some areas an approved backflow prevention device may be required between the brewer and the water supply.

1. A 3/8" Flare x 3/8" Male pipe elbow is supplied with the brewer for water line connection. Use tubing sized sufficiently to provide a minimum of 1.0 GPM.
2. Connect the unit to an appropriate electrical power circuit.
3. Turn on the toggle (STANDBY/ON) switch behind the unit. The heating tank will start to fill. When the water level in the tank rises to the correct volume, the heating elements will energize automatically. With ADS Systems there is no danger of element burnout caused by an empty tank.
4. The heating tank will require 20 to 30 minutes to reach operating temperature (200°F), indicated when READY TO BREW is displayed on the LCD screen.
5. Prior to brewing, dispense 12 ounces of hot water through the hot water faucet.
6. Brew a cycle of at least 12 ounces, to purge the water lines of any air that may be trapped after filling.

BREWING INSTRUCTIONS

1. Brewer should be ON (Confirm at rear toggle switch, then press the ON/OFF button). Ready-to-Brew should be on the display. If the brewer is connected to an InterLock grinder, the grinder should be on. When Interlock connection is made, grind coffee at this time.
2. Place an empty Satellite under the brewcone and press the warmer switch to pre-heat the Satellite.



3. Place a clean filter into the brewcone.



4. Fill brewcone with ground coffee.

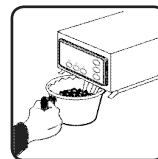

5. Transfer filled brewcone to brewer.

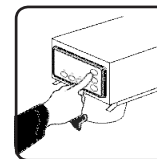

6. Press Brew button. Brewing will begin immediately.



WARNING TO AVOID SCALDING, Do not remove brewcone while brew light is flashing.



ISO 9001 REGISTERED

WILBUR CURTIS COMPANY
Montebello, CA 90640

Quick Start

GEM TS & GEM SS

Your Curtis ADS System is Factory Pre-Set for Optimum Performance.

After connection to water and power; the rear toggle switch must be on. You will hear a beep sound, indicating power is available to the controller.

The control displays **CURTIS**. Press ON/OFF button and the screen will display **<GEMINI TWIN> WILBUR CURTIS**. After three seconds, **CURTIS FILLING** is displayed.

Water will fill the tank (approximately 2-3 minutes depending on water flow rate). When the proper level is reached **CURTIS HEATING** will appear on the screen. It takes approximately 20 minutes to reach setpoint temperature of 200°F.

Control will display **CURTIS READY TO BREW** when temperature reaches the setpoint (200°F). Unit is now ready to brew.

PROGRAM MENUS

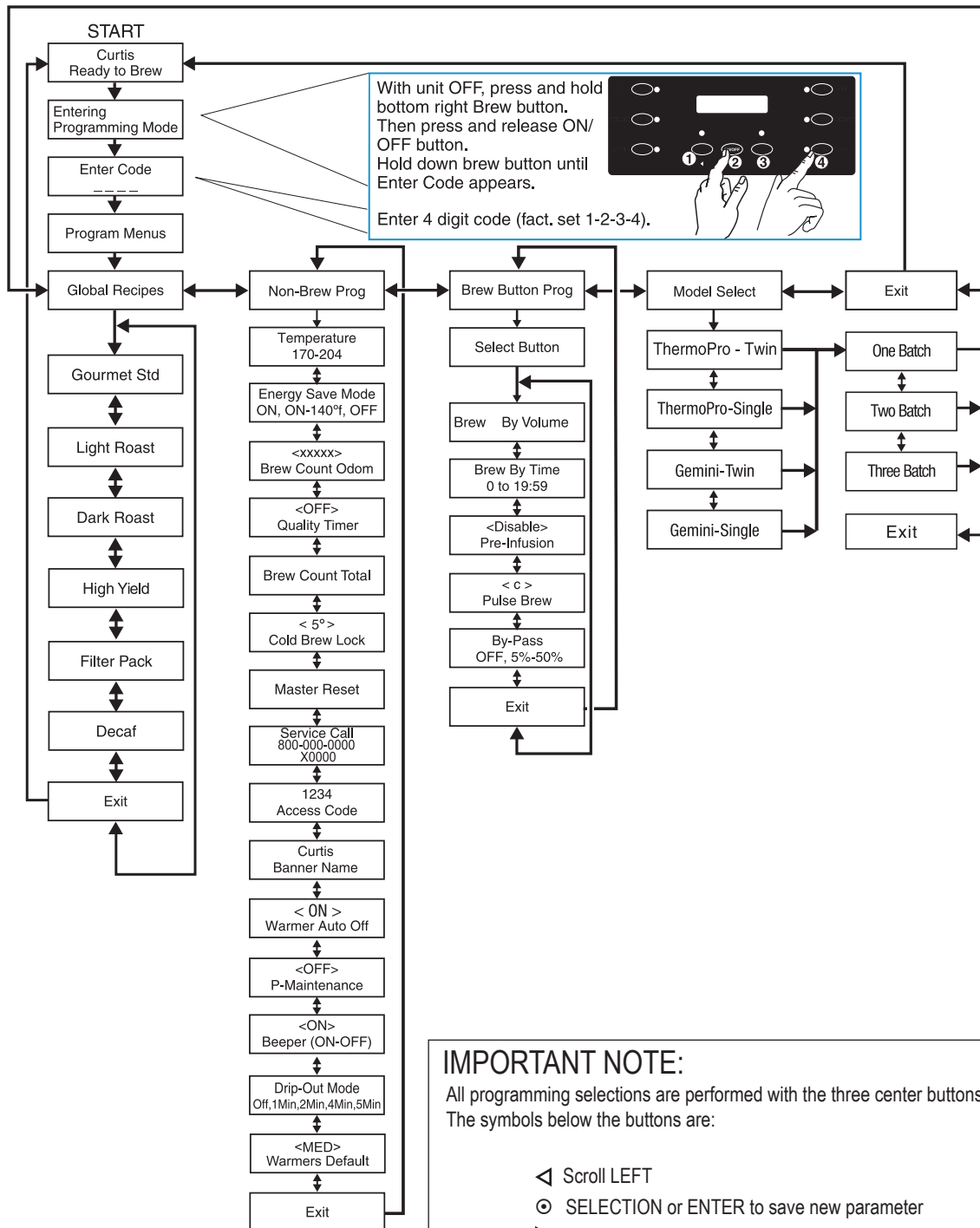

PARTS DIAGRAMS

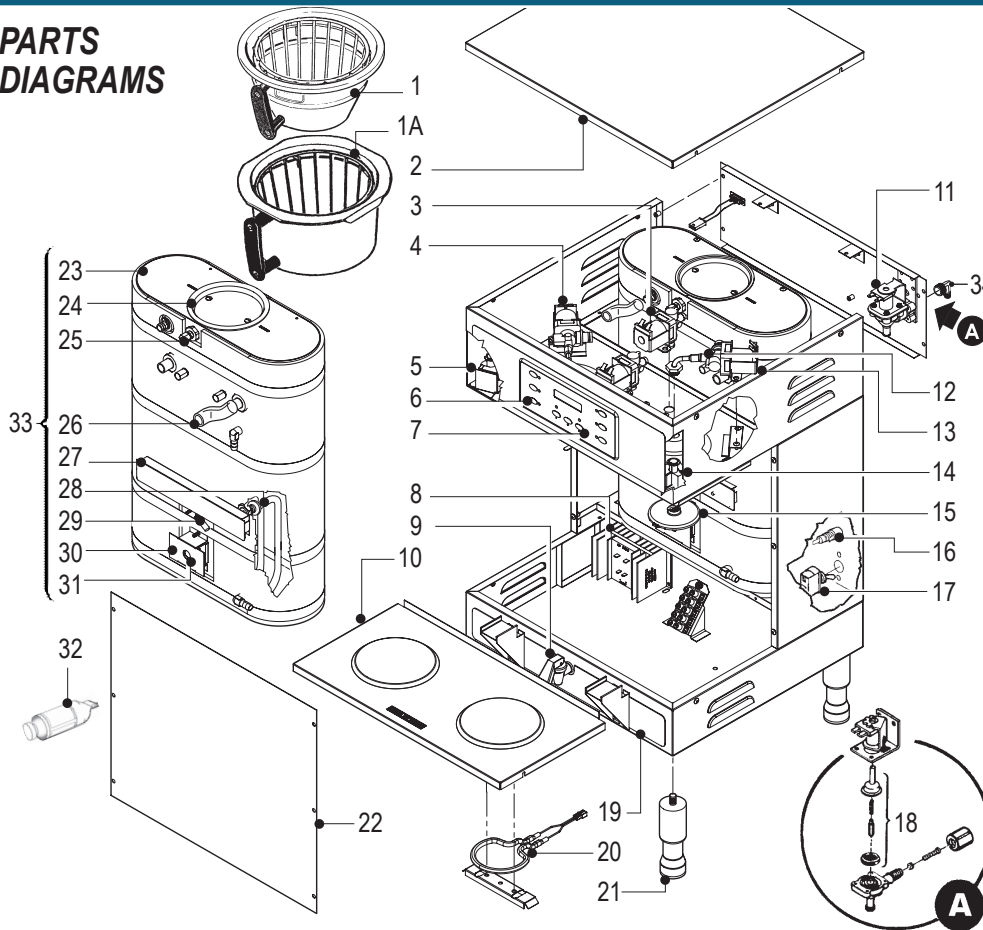

GEM TS

Nº	Part Nº	Description
1	WC-3357	BREWCONC W/HANDLE
1A	WC-3354	BREWCONC, GOURMET LRG CAP
2	WC-5421	COVER, TOP
3	WC-844-101*	KIT, VALVE BY-PASS NON-ADJUST
4	WC-37121 *	KIT, DUMP VALVE LEFT
5	WC- 441	SOLENOID, LOCK BREWCONC LEFT
6	WC-39395	LABEL, UCM OVERLAY DUAL TWIN
6A	WC-39440	LABEL, CONTL PANEL 3 BATCH
6B	WC-39439	LABEL, CONTL PANEL 2 BATCH
6C	WC-39438	LABEL, CONTL PANEL 1 BATCH
7	WC-37176*	KIT, UCM CONTROL MODULE
8	WC-8559	RELAY, SOLIDSTATE 40A W/HT SNK
9	WC-1809 *	FAUCET, HOT WATER
10	WC-5423	DECK ASSY NO HEATING ELMTS
11	WC- 847 *	VALVE, INLET
12	WC-2977-101	FITTING, SPRAYHEAD ULTEM
13	WC-37122 *	KIT, DUMP VALVE RIGHT
14	WC- 442	SOLENOID, LOCK BREWCONC RIGHT
15	WC-29050	SPRAYHEAD, AFS-AMBER
16	WC-1501	FUSE HOLDER ASSY W/5A FUSE
17	WC- 102 *	SWITCH, TOGGLE
18	WC-3765L*	KIT, VALVE REPAIR
19	WC-39462	LABEL, BOTTOM PANEL GEMTS
20	WC-37102*	KIT, WARMER ELEMENT
21	WC-3528 *	LEG, 4" ADJUST 3/8-16 THRD ITALIAN
22	WC-5829	COVER, FRONT
23	WC-54287	TANK, ASSY TPS1T/GEMTS
24	WC-37008*	KIT, TANK LID ROUND
25	WC-37278	KIT, LIQUID LEVEL PROBE GT
25A	WC-5502 *	PROBE ASSY, WATER LEVEL
26	WC-5350	TUBE, 1/2" ID x 1/8W SILICONE
27	WC-4382	GUARD, SHOCK HEATING ELEMENT
28	WC- 934-04*	ELEMENT HEATING 2.5KW 220V
29	WC-1438-101*	SENSOR, HEATING TANK
30	WC-43055	GUARD, SHOCK RESET T-STAT
31	WC- 522 *	THERMOSTAT, RESET
32	WC-5231 *	COMPOUND, SILICONE
33	WC-62033	TANK, CMPLT GEMTS W/ULTEM FTNG
34	WC-2402	ELBOW, 3/8"FL x 3/8" M. PIPE

* Recommended parts to stock.

GEM SS

Nº	Part Nº	Description
1	WC-58117	COVER, TOP
1A	WC-5450	COVER, TOP (OLDER UNITS)
2	WC-37122*	KIT, DUMP VALVE RIGHT
3	WC-39436	LABEL, CONTROL PANEL 3 BATCH
3A	WC-39432	LABEL, CONTROL PANEL 1 BATCH
3B	WC-39434	LABEL, CONTROL PANEL 2 BATCH
4	WC-3357	BREWCONC ASSY COMPLETE
5	WC-29050*	SPRAYHEAD, AFS-AMBER
6	WC-5452	COVER, FRONT
7	WC-8559 *	RELAY, SOLID ST W/INTGRD HT SNK
8	WC-39448	LABEL, BOTTOM WRAP GEMSS
9	WC-1809 *	FAUCET, HOT WATER
10	WC- 847 *	VALVE, INLET 2GPM 120V 10W
11	WC-2402	ELBOW, 3/8"FL x 3/8" M. PIPE
12	WC-37130*	KIT, VALVE BYPASS
13	WC-1501	FUSE HOLDER ASSY W/5A FUSE
14	WC- 102 *	SWITCH, TOGGLE 125V, 80A
15	WC-3528	LEG, 4" ADJUST 3/8-16 THRD ITAL
16	WC-5451	WARMER DECK - NO HTG ELMTS
17	WC-38310	LABEL, CAUTION HOT SURFACE
18	WC-37102*	WARMER ELEMENT
19	WC-3765L*	KIT, VALVE REPAIR
20	WC-37132*	KIT, VALVE REPAIR
21	WC-2977-101	FITTING, SPRAYHEAD ULTEM
22	WC-37176*	KIT, UCM & LABEL, INSTRUCTIONS
23	WC-5853-102	COVER, TOP HEATING TANK GEN USE
24	WC-62035	TANK, COMPLETE GEMSS W/ULTEM
24A	WC-62034	TANK, COMPLETE GEMSS DV ULTEM
25	WC-37278	KIT, LIQUID LEVEL PROBE GT
25A	WC-5502-01*	PROBE ASSY, WATER LEVEL
26	WC- 522*	THERMOSTAT, RESET
27	WC-43055	SHOCK GUARD, RESET THERMOSTAT
28	WC- 906-04*	HEATING ELEMENT, 2000W 220V
28A	WC- 904-04	ELEMENT, HEATING 1.6KW 120V
29	WC-5350	TUBE, 1/2" ID x 1/8W SILICONE
30	WC-43801	SHOCK GUARD, HEATING ELEMENTS
31	WC-1438-101*	SENSOR, TEMP HEATING TANK
32	WC-5231 *	COMPOUND, SILICONE 3/4 OZ TUBE

* Recommended parts to stock.

ELECTRICAL SCHEMATIC GEM TS

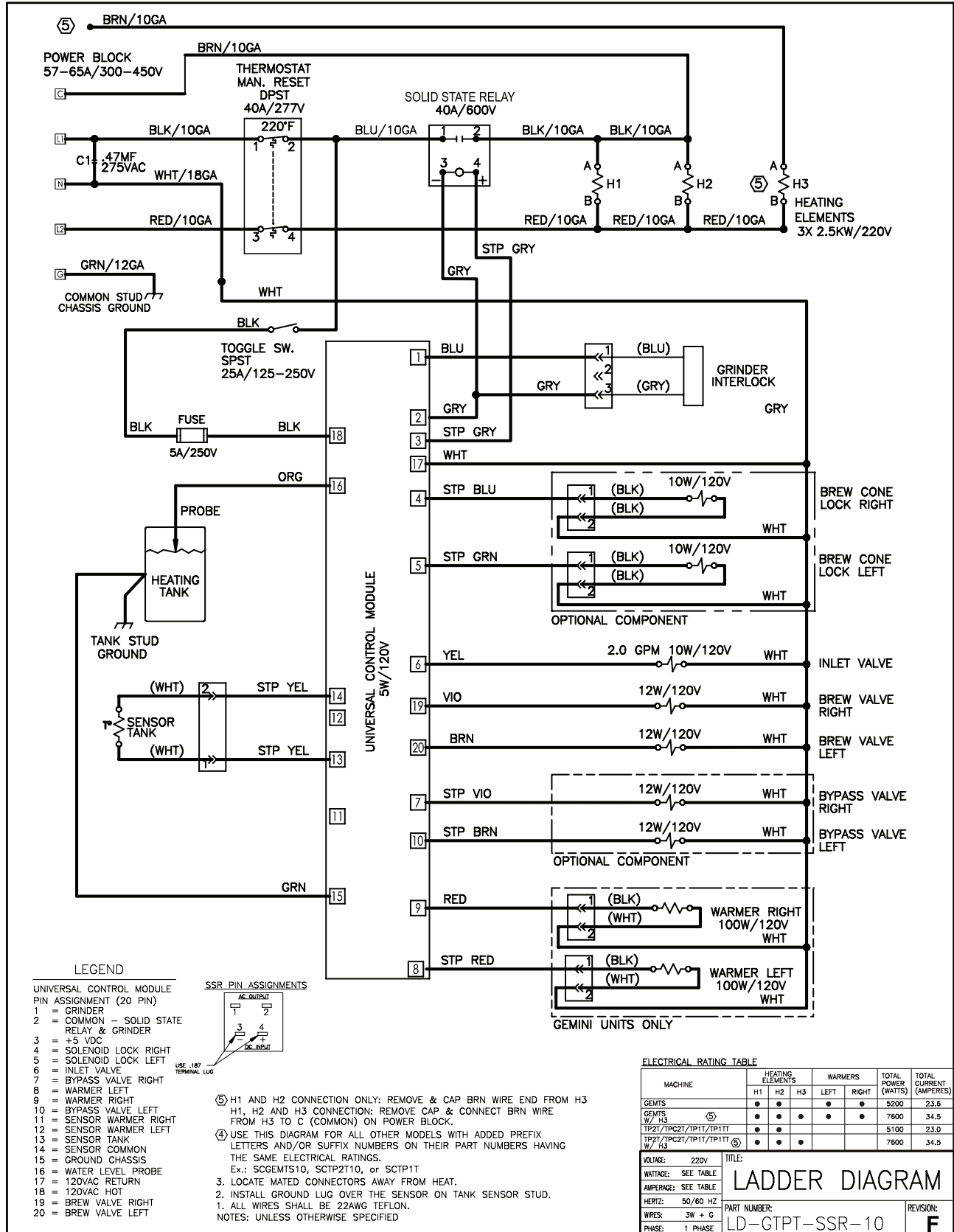

ELECTRICAL SCHEMATIC

GEM SS

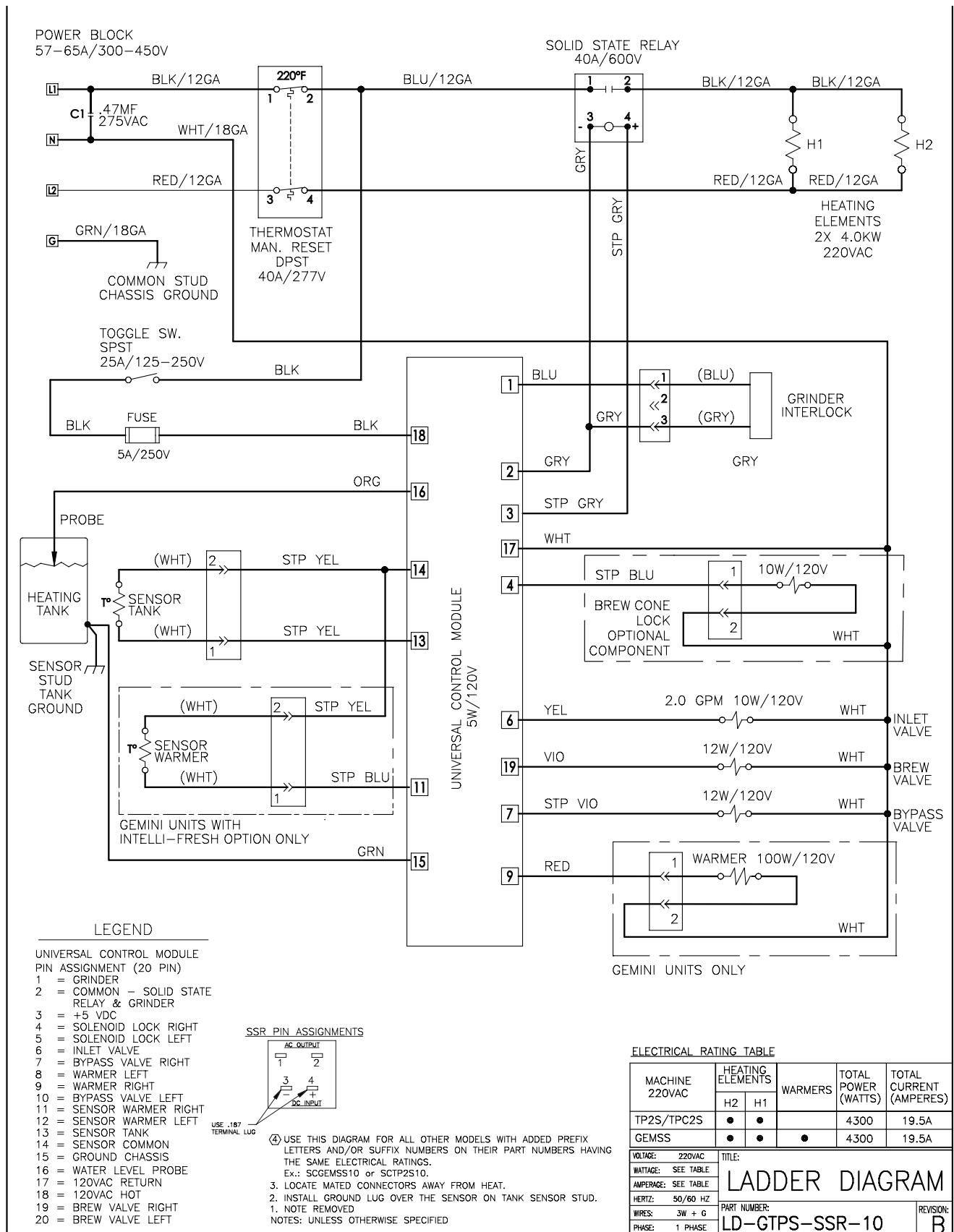

Product Warranty Information

The Wilbur Curtis Company certifies that its products are free from defects in material and workmanship under normal use. The following limited warranties and conditions apply:

- 3 Years, Parts and Labor, from Original Date of Purchase on digital control boards.
- 2 Years, Parts, from Original Date of Purchase on all other electrical components, fittings and tubing.
- 1 Year, Labor, from Original Date of Purchase on all electrical components, fittings and tubing.

Additionally, the Wilbur Curtis Company warrants its Grinding Burrs for Forty (40) months from date of purchase or 40,000 pounds of coffee, whichever comes first. Stainless Steel components are warranted for two (2) years from date of purchase against leaking or pitting and replacement parts are warranted for ninety (90) days from date of purchase or for the remainder of the limited warranty period of the equipment in which the component is installed.

All in-warranty service calls must have prior authorization. For Authorization, call the Technical Support Department at 1-800-995-0417. Effective date of this policy is April 1, 2003.

Additional conditions may apply. Go to www.wilburcurtis.com to view the full product warranty information.

CONDITIONS & EXCEPTIONS

The warranty covers original equipment at time of purchase only. The Wilbur Curtis Company, Inc., assumes no responsibility for substitute replacement parts installed on Curtis equipment that have not been purchased from the Wilbur Curtis Company, Inc. The Wilbur Curtis Company will not accept any responsibility if the following conditions are not met. The warranty does not cover and is void under the following circumstances:

- 1) **Improper operation of equipment:** *The equipment must be used for its designed and intended purpose and function.*
- 2) **Improper installation of equipment:** *This equipment must be installed by a professional technician and must comply with all local electrical, mechanical and plumbing codes.*
- 3) **Improper voltage:** *Equipment must be installed at the voltage stated on the serial plate supplied with this equipment.*
- 4) **Improper water supply:** *This includes, but is not limited to, excessive or low water pressure, and inadequate or fluctuating water flow rate.*
- 5) **Adjustments and cleaning:** *The resetting of safety thermostats and circuit breakers, programming and temperature adjustments are the responsibility of the equipment owner. The owner is responsible for proper cleaning and regular maintenance of this equipment.*
- 6) **Damaged in transit:** *Equipment damaged in transit is the responsibility of the freight company and a claim should be made with the carrier.*
- 7) **Abuse or neglect (including failure to periodically clean or remove lime accumulations):** *Manufacturer is not responsible for variation in equipment operation due to excessive lime or local water conditions. The equipment must be maintained according to the manufacturer's recommendations.*
- 8) **Replacement of items subject to normal use and wear:** *This shall include, but is not limited to, light bulbs, shear disks, "O" rings, gaskets, silicone tube, canister assemblies, whipper chambers and plates, mixing bowls, agitation assemblies and whipper propellers.*
- 9) **Repairs and/or Replacements** *are subject to our decision that the workmanship or parts were faulty and the defects showed up under normal use. All labor shall be performed during regular working hours. Overtime charges are the responsibility of the owner. Charges incurred by delays, waiting time, or operating restrictions that hinder the service technician's ability to perform service is the responsibility of the owner of the equipment. This includes institutional and correctional facilities. The Wilbur Curtis Company will allow up to 100 miles, round trip, per in-warranty service call.*

RETURN MERCHANDISE AUTHORIZATION: *All claims under this warranty must be submitted to the Wilbur Curtis Company Technical Support Department prior to performing any repair work or return of this equipment to the factory. All returned equipment must be repackaged properly in the original carton. No units will be accepted if they are damaged in transit due to improper packaging. **NO UNITS OR PARTS WILL BE ACCEPTED WITHOUT A RETURN MERCHANDISE AUTHORIZATION (RMA). RMA NUMBER MUST BE MARKED ON THE CARTON OR SHIPPING LABEL.** All in-warranty service calls must be performed by an authorized service agent. Call the Wilbur Curtis Technical Support Department to find an agent near you.*



WILBUR CURTIS CO., INC.

6913 Acco St., Montebello, CA 90640-5403 USA

Phone: 800/421-6150 ♦ Fax: 323-837-2410

♦ Technical Support Phone: 800/995-0417 (M-F 5:30A - 4:00P PST)

♦ Web Site: www.wilburcurtis.com

♦ E-Mail: techsupport@wilburcurtis.com